

*Forward-thinking  
architecture.*

ARCHITECTURAL DESIGN  
AND SELECT CASE STUDIES



DDD  
GROUP



# We're not your typical architects.

Thanks to decades of design-build experience, DDD Group's design and construction teams work hand in hand under one roof, with owners, consultants, subs, and suppliers to develop multi-dimensional solutions to everyday needs.

Architects are more than just a designer—they are your advocate from start-to-finish, helping with permits, project coordination, advice, and guidance as you bring your mental concepts into tangible reality. A good architect will see potential hurdles in your project you may not have predicted and find easy solutions you may not have realized existed. Therefore, just as you would carefully consider the selection of a reliable vehicle, you want to be selective in your choice of an architect who will navigate you through the course of your project and save you valuable time and money.

Impressive design has always been a staple in the DDD toolkit. Strategic, timeless and efficient architectural design is part of our unified, data-driven process of project delivery. We listen carefully to each client's needs and develop concepts that resonate with their financial framework, while fulfilling their aesthetic goals. Combining research and creativity, we develop and clearly communicate strategic ideas and conceptual alternatives that culminate in buildable and sustainable environments. As our reputation indicates, all our architectural design projects are within budget, functionally sound, aesthetically pleasing and cost-effective to operate and maintain. Contact us today to put our design muscle to the test.



## Deep Architectural Expertise

Our architectural team can work with the client before and throughout the development to validate their vision and work efficiently to make it a reality, supported by extensive on-the-field experience in construction and long-term maintenance. Years of design-build experience have molded a unique culture at DDD. Our approach to design services gives clients the added value of an integrated practice with an in-depth understanding of the cost, schedule and life cycle implications of their design recommendations. Design and construction teams work hand in hand under one roof, with owners, consultants, subs, and suppliers to develop multi-dimensional solutions to everyday needs.

## Discover Resilient Design

At DDD we are proud advocates for sustainable, intelligent design that honors the environment and provides low impact. As award-winning leaders in Energy Conservation, we pride ourselves in providing clients with feasible, yet sustainable solutions that serve their needs, while observing the best and most relevant trends in conservation. DDD is a member of the United States Green Building Council (USGBC) with LEED accredited professionals, and experienced personnel to help you explore opportunities to BUILD GREEN.

## Design for Constructability

Our architectural team can work with the client before and throughout the development to **validate your vision** and work efficiently to make it a reality. The comprehensive design process is supported by extensive on-the-field experience in construction and long-term maintenance. DDD's approach to design services gives clients the added value of an integrated practice with an in-depth understanding of the cost, schedule and life cycle implications of our design recommendations.

- Materials Selection
- Safety and Physical Security
- Modularity and Scalability
- Code Compliance
- Integrated Workflows





## PRBAHS



Understanding that the quality of both interior and exterior spaces influences human behavior, various concept ideas were explored. Adding natural light into a totally artificially lit space was a priority. Glass storefront perimeter windows and skylights were added to the building's exterior. We strategically incorporated color psychology, in addition to architectural volumes. We created unique interior and exterior gathering spaces for both occupants and visitors, and gave each space custom design elements that truly transformed the space.



When exploring big changes and strong conceptual ideas, the sky is the limit. 3D modeling is the perfect tool to explore this. Our modeling technology helped us demonstrate our experimental design concept and helped our client visualize our design intent. We are fully aware that this very ambitious concept needs to be turned into reality and more importantly, constructible. Further use of 3D modeling technology in the design phases helped us achieve this very important goal.

[\*\*LEARN MORE\*\*](#)



## CBP Satellite Lab, Mayagüez



For this Design-Build project, we were entrusted to create a new Satellite laboratory for the US Customs and Border Protection agency in Mayagüez, PR.

The design and construction of this new satellite facility, located in a historic building in Mayagüez, includes architectural, electrical, and mechanical work, as well as data, security systems, new laboratory fixtures, furniture and equipment. Other improvements include a laboratory-grade 100% Fresh Air Variable-air-volume (VAV) HVAC system operating under negative pressure, to protect occupants from dangerous vapors.

The scope of work also included the installation of fume hoods and snorkel vents, chemical-resistant finishes, and plumbing. Other enhancements to the structure included access control, intrusion detection, and video surveillance systems as well as improvements to the power distribution and a new central uninterruptible power supply system (UPS).

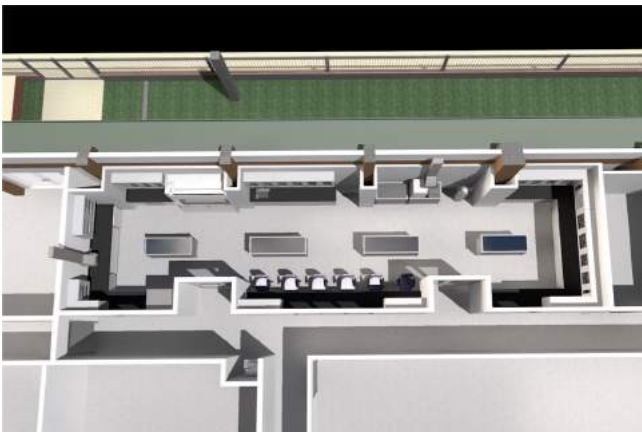

[LEARN MORE](#)





## Ciudad Lumen Phase II



New construction of a 172,000-SF, mid-rise housing condominium for low-income individuals ages 62 years and older. This housing project encompasses 12 stories and is comprised of 122 housing units as well as a 120 car parking structure. It includes one bedroom, handicapped and specialized bariatric units. In addition, the building provides multiple reading and lounge areas, meeting rooms and a state-of-the-art gym.

In close similarity to **Phase I**, Ciudad Lumen II is designed to achieve "Permiso Verde" Sustainable Project Certification. The project incorporates multiple site sustainability, energy efficiency, water efficiency, materials, resources and indoor environmental quality strategies. Some of these included the installation of low-energy glazing, cool roofs, water-sense fixtures, energy star appliances, light-emitting diode (LED) lighting, occupancy sensors, bicycle racks, preferred parking for low-emission vehicles, renewable energy sources (solar panels) and various other improvements.



[\*\*LEARN MORE\*\*](#)





## Caribbean University



Designed and built by DDD, the project involved the demolition and replacement of an existing facility in order to house the new Student Services and Administration Building for Caribbean University in Bayamon. The project consisted of ground level parking, green areas and a 6 story cast in place concrete structure. In the basement, the facility housed the university's central data center. An additional 4 levels of office and student services space occupied the upper floors.



At the top level, the design included a roof terrace and a clock/bell tower. The building's interiors included very high end finishes, floor to ceiling marble cladding, extensive millwork and high end modular office systems. Multiple sustainability strategies were incorporated. Some of these strategies included the use of high-efficiency A/C units, insulated glass panels, low-e and reflective glass.

[\*\*LEARN MORE\*\*](#)



***Built for the job.***

Thanks to decades of design-build experience, DDD Group's design and construction teams work hand in hand under one roof, with owners, consultants, subs, and suppliers to develop multi-dimensional solutions to everyday needs.

Trust your project to the experts in construction and strategic planning at DDD Group. With an acumen of over 22 years and hands-on experience in a variety of fields (ranging from healthcare, to commercial, corporate projects, multi-family residential and federal restoration projects), DDD is truly **built for the job**.

## **DDD Group**

PO Box 11976  
Caparra Heights Station  
San Juan, Puerto Rico 00922-1976

Tel (787) 706-8000  
Fax (787) 706-8014  
[info@dddpr.com](mailto:info@dddpr.com)